

Flowergardens

There are numerous flower gardens for visitors to visit and relish the beauty and unique scent of spring. Various services are also built among the flower gardens to increase the convenience of the place.

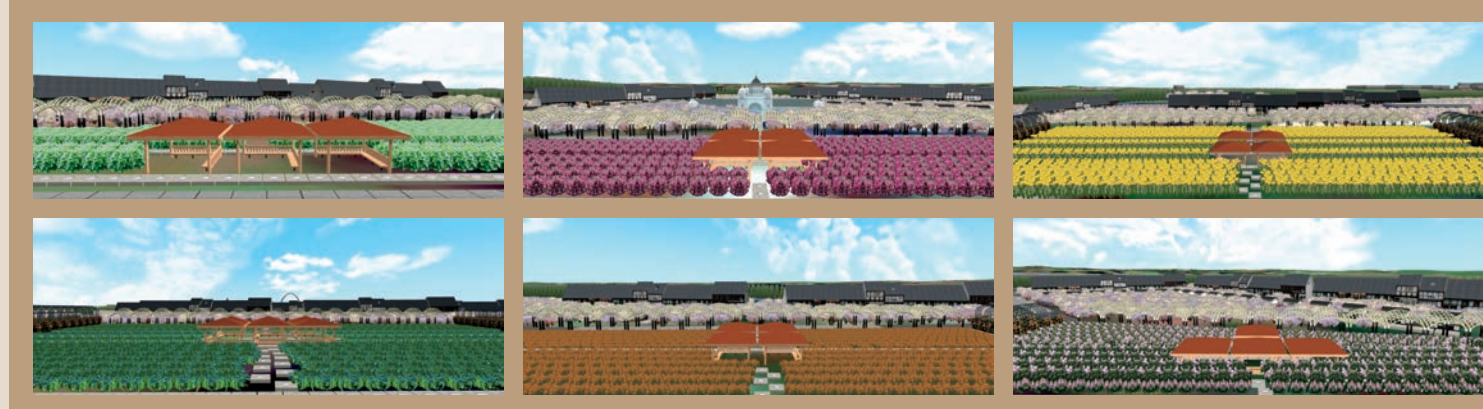

Sakura Forests

Growing around the park, the cherry blossom forest, a springtime feature, is one of the bright spots that give this place color and charm.



Main Layout

Spring park is awash in fragrance and color with 6 hexagonal zones designed to be the campsites and farms. These zones are organized in order to form the 6 petals shape.

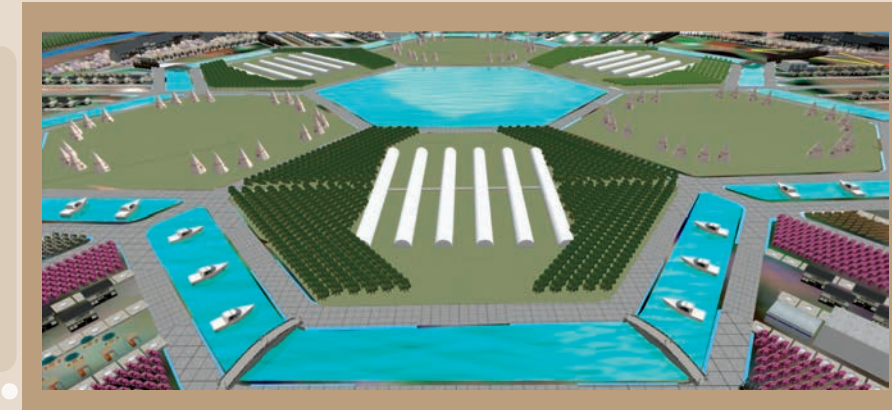

Organic Farms

Besides, customers can also take time to visit our orchards - awesome places to pluck fruits and taste them right on the premises.



Water Conduit Transport System

- To bring a new, eco-friendly way of transportation to visitors, a water conduit system has been built enclosing the whole plan area.
- The conduit system use water pressure as the main dynamic to control the water speed. In high speed zone, water are supplied through pumps was attached throughout the conduit.
- This water, then, was reused for the pump system, fire suppression or recycling.

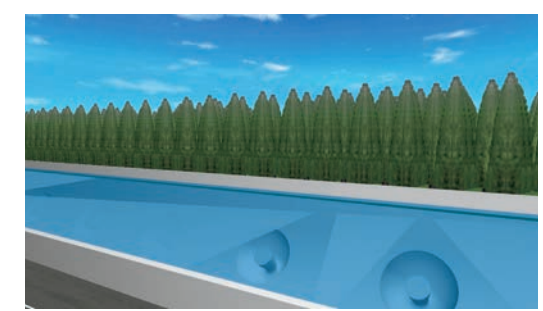

Ethereal Happiness

SPRING PARK
The 12th Virtual Design World Cup
A powerful attack combined with hundreds of fragrances and colors of the blooming season that hits straight to the senses

SUMMER PARK
in the middle of the city
An eventful, recreation location with an artificial beach laying right

PURPOSES:
The theme park is constructed to create an eco-friendly, stress-relieving location for travelers who are fed up with waiting for airport check-in and delay incidents. Our target customers are not only people from the airport but also from surrounding areas to visit. Serving as a tourist attraction.

WINTER PARK
Chills and excitement will run through your body as soon as you step into this winter wonderland.

AUTUMN PARK
Used Products: UC/Win-Road; Shade3D
This place is created to promote lightness, calm, and tranquility, bringing comfort and relaxation to everyone.

DESIGN CONCEPT:
Our plan is divided into 4 zones, each zone has its unique features of 4 seasons. Ensuring absolute security, the theme park is linked directly to the airport lounge and this will allow visitors to commuted back and forth between the airport lounge and the plan area. The project also focus on soundproofing methods, like: using sound insulation construction materials or creating tree ring surrounding the area.

Swimming Pool

From the main layout, each pool offers a distinct form of entertainment services: extreme games, children's area... Especially, a large stage is held at the central pool, to perform exciting activities to show tourists the true heat of the summer.

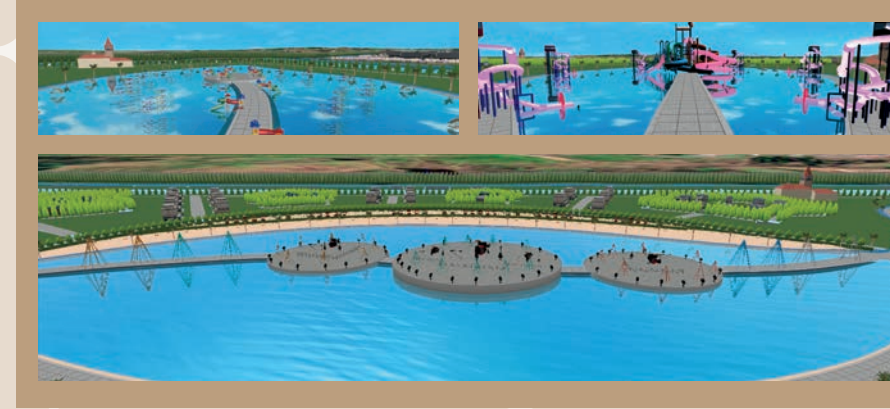

Main Layout

Summer park consists of three swimming pools built in the shape of three consecutive leaves.

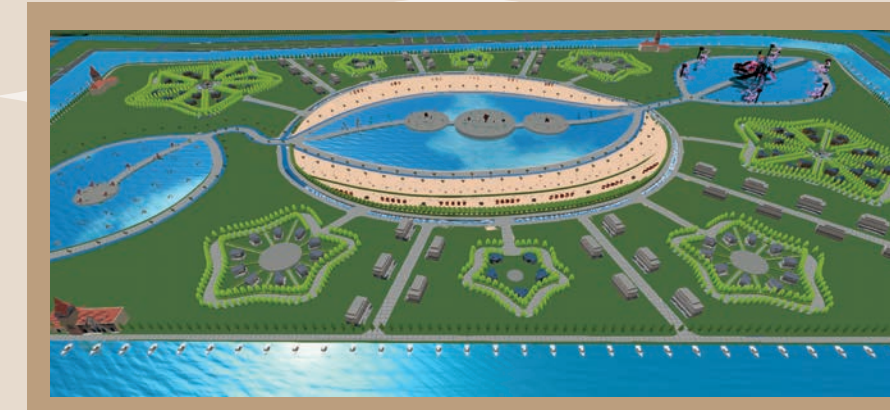

Dome Aquarium

The leaf border is an underground aquarium with a dome-shaped design. It gives guests the impression that they are exploring new creatures underwater as they enter.

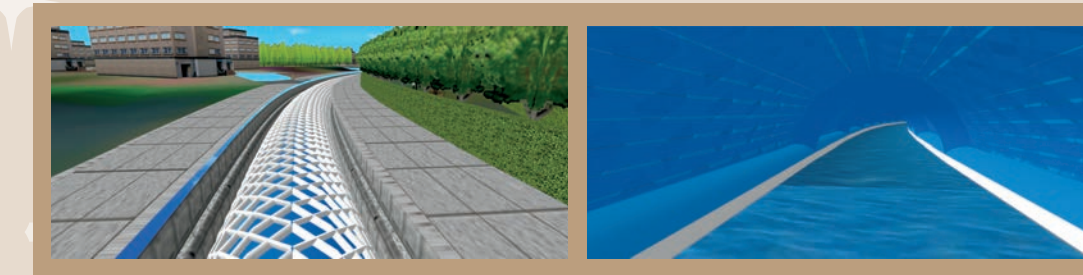

Typical Services

Multiple options of services and accommodations are also provided: bars, restaurants, and sunbathing for visitors to enjoy.



Non-touch AI

- Every person in the city will be scanned for facial data and personal data to ensure security in the city.
- Fair amount of cameras will be equipped. This system was controlled by AI technology and has thermal sensors to supervise visitors' health status.
- Touchless check-in, check-out and payment system.

Metaverse in Entertainment
In our plan, just by wearing a VR glasses, people can attend memorable live stages with virtual idols or attend challenging Winter race

Transportation

Special mean of Transport

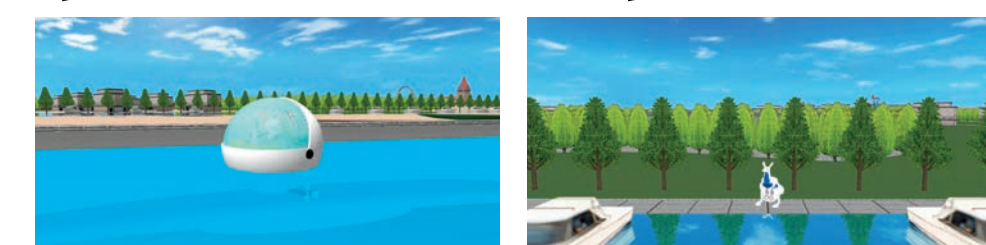

To travel on water conduit system, a special vehicle was designed. Using solar energy, however, most of the energy is used not to run the vehicle but only to navigate. It is also equipped with AI assistants, which provides information, pre-register services, or analyze map, select proper routes and destinations. Besides we also placed Kangaroo robots to make the travelling process more exciting.

Commercial Street

Beside indoors and outdoors entertaining services, the park also creates places for people to go shopping, dining or just simply take time to enjoy the gorgeousness of Winter.

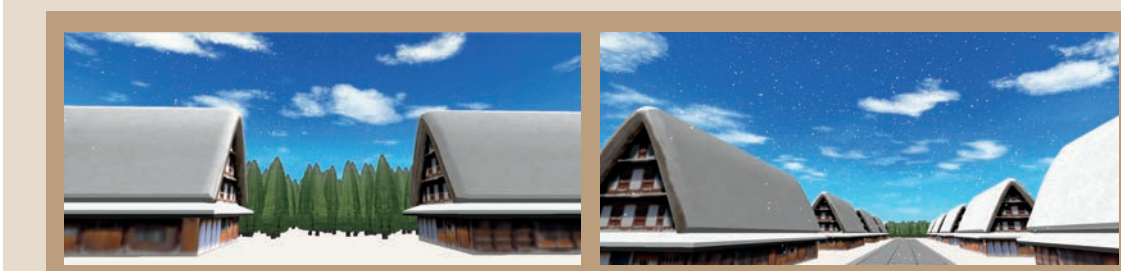

As for the accommodation services, we provide hotels that simulate the Japanese classical design. By this design, we want to create an ancient vibe besides modern facilities.

Housing

The outdoor race is built along the snowflake petals. Along with the racetrack, pit stops and takeaway shops are also placed. Tourists, who take part in this recreational service, will get the opportunity to behold the whole view of the winter park.

Ice Race

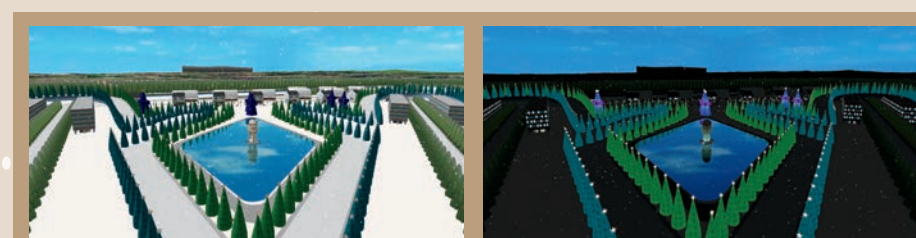

Main Layout

The overall plan is inspired by the snowflake. In the middle of the park also include indoor ice ring, which is equipped Metaverse Tech in order to bring visitors unheard of experiences.

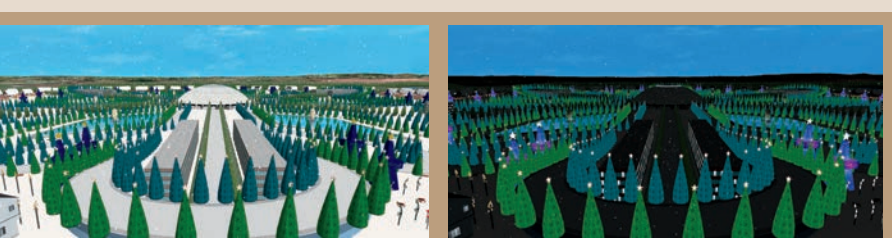
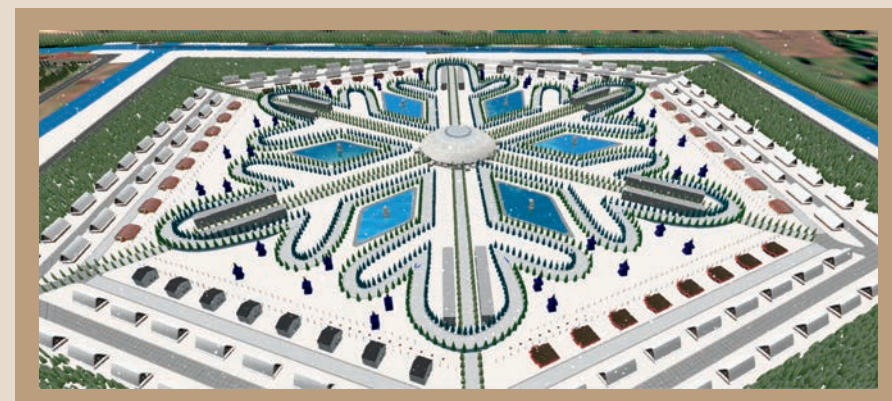

Technology

Smart Management System

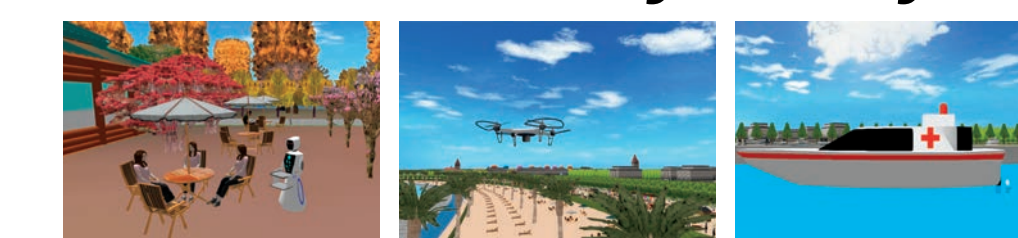

Robots: All staffs, from assistants to managers, are robots. This will make service process become more hygiene, minimize the thread of spreading disease.

Drones: The drones work as security guards, handlers, who deliver baggage and ship stuffs for customers

Smart Mobile Hospital: This is a needed method to quickly cope with unexpeted incidents.

Wine Cellar



Aside from the maple leaf, local products like: apples, grapes, blueberry are planted enclosing wine cellars. Tourist can make their own wine by using fresh fruits



Lying in the middle of the tulip garden, each homestay are built separately. This design will create a peaceful and comfortable feeling for visitors the moment they enter

Homestay

Main Layout

Dining Zone

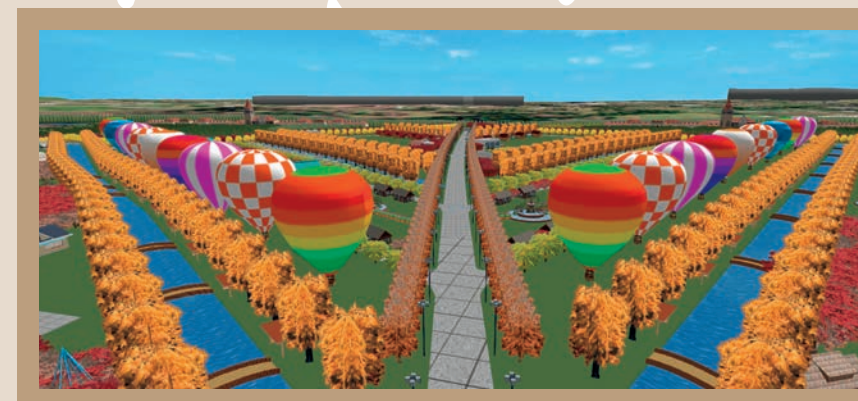

Lying right next to the coffee area, the pink lakes simulate Hiller lake which is one signature of Australia.



Built in the middle of forest, the coffee shops orientate introverts to enjoy café while immersing themselves in nature.



Especially, we use a hot air balloon as a dining destination where guests can enjoy a meal and an amazing view of whole autumn parks