

JINDAI 神代

3DCAD
ENDLESS POSSIBILITIES

FORUM 8
concept design studio

UC-winRoad

VR CLOUD

OpenVFOAM

UC-1 シリーズ

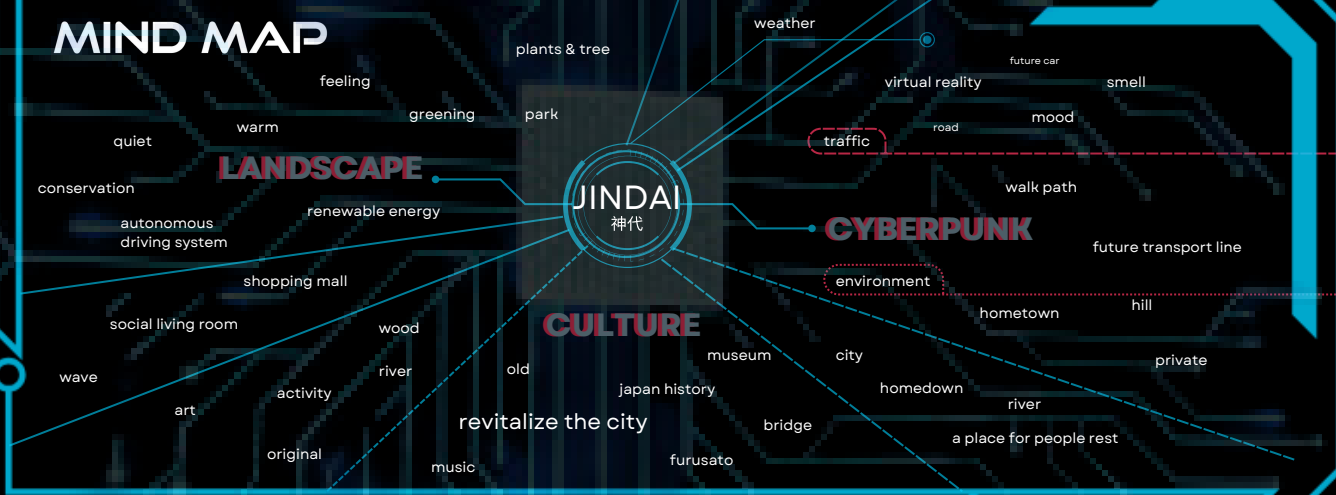

CONCEPT

果	氣	ウツホ	○	ATMOSPHERE
葉	冷	ミツ	∩	RESIDENTIAL
支	熱	カセ	△	PUBLIC SPACE
柱	液	ホ	≡	TRANSPORT
根	固	ハニ	□	MUSEUM

"JINDAI" will become a master plan for Ena City's future lifestyle. The environment evokes Japanese nostalgia. To strike a balance between artificial intelligence technology and historical natural features. We got inspiration from the topography of Ena City, where the waves of the original landscape connect innovative conceptual systems that reverse the fluidity of Ena City. Taking JINDAI's "text visualization" as the central concept and referencing Japan's ancient culture, the city will develop and expand vertically in a better-diversified way.

LAND USE



SITE CIRCULATION

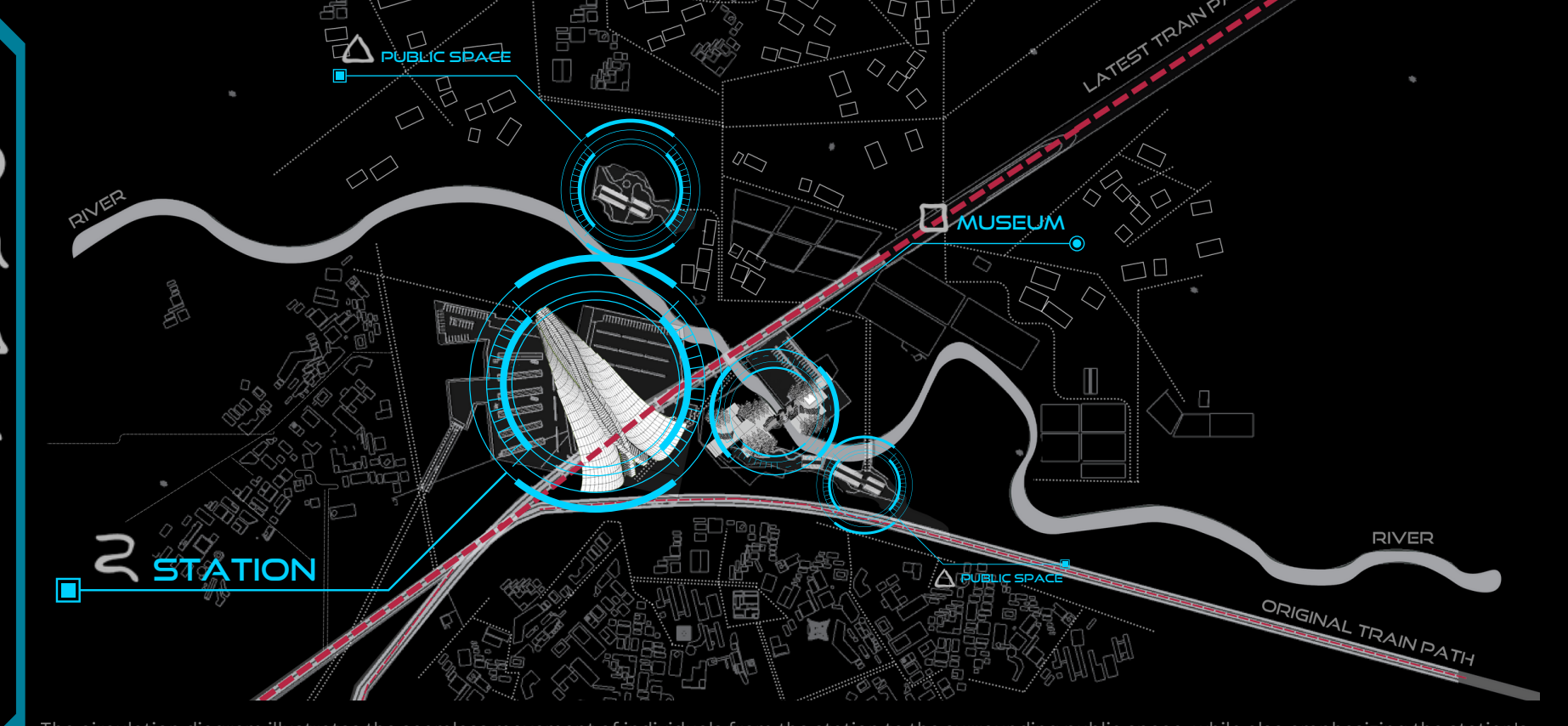

STATION

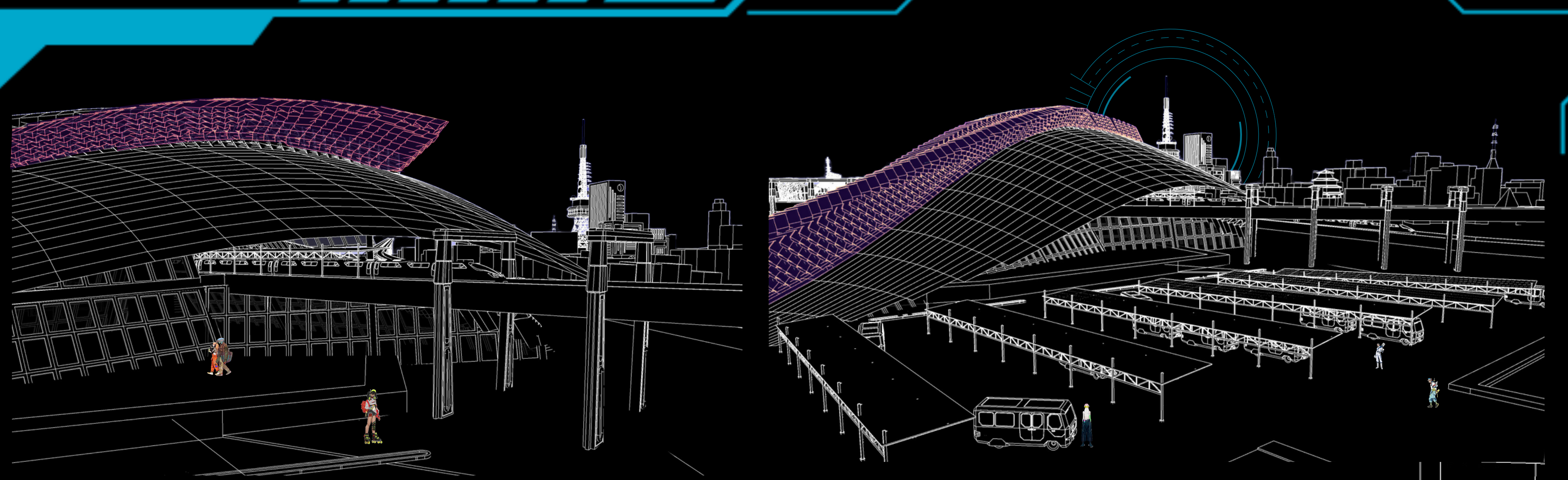

OTHER FACILITIES

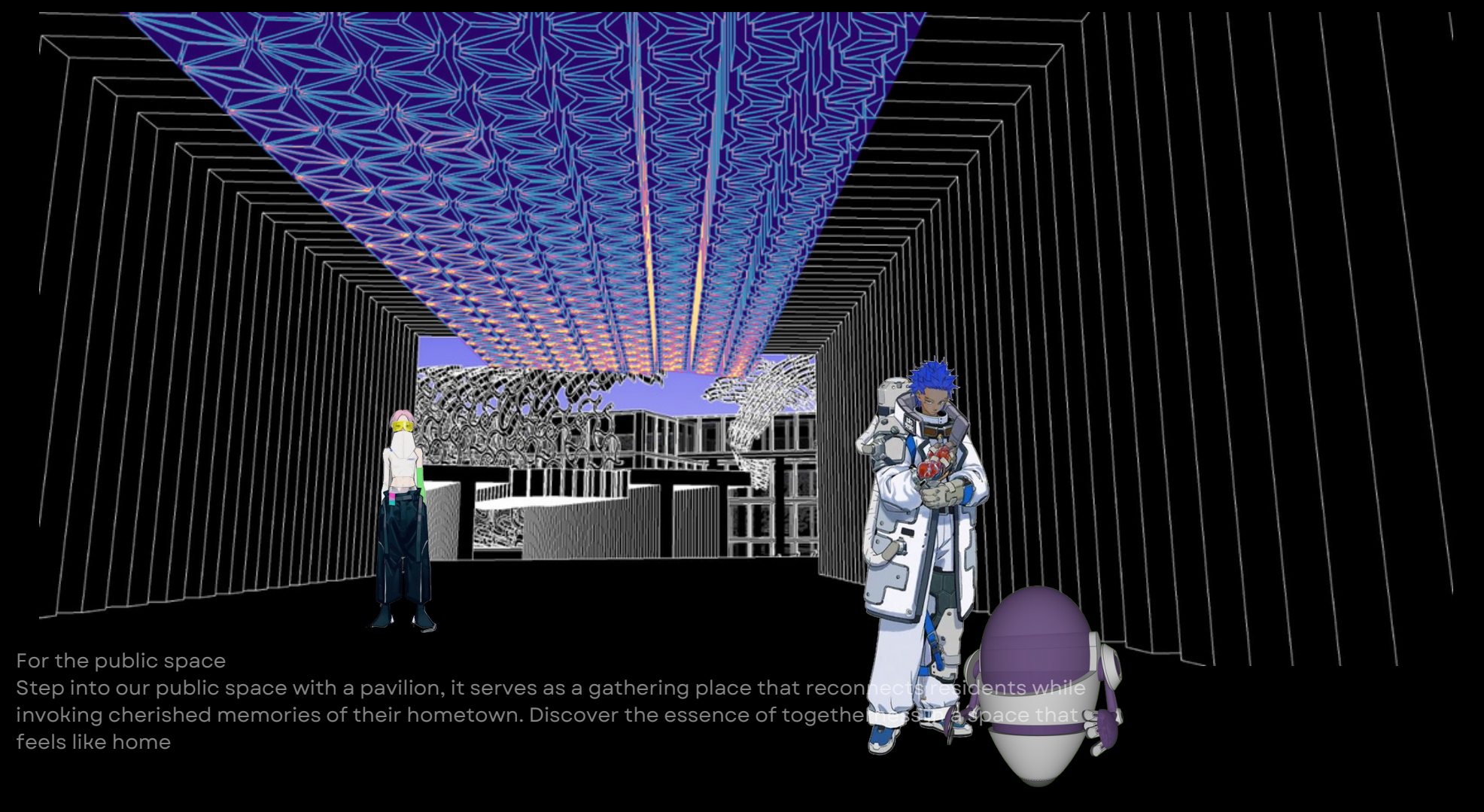

For the museum:
Immerse yourself in the rich history, vibrant culture, and captivating music of Ena City at the museum. Through the symbol of JINDAI, to discover the city's heritage and traditions, offering a journey that resonates with visitors, connecting them to the soul of Ena City.

TRAIN

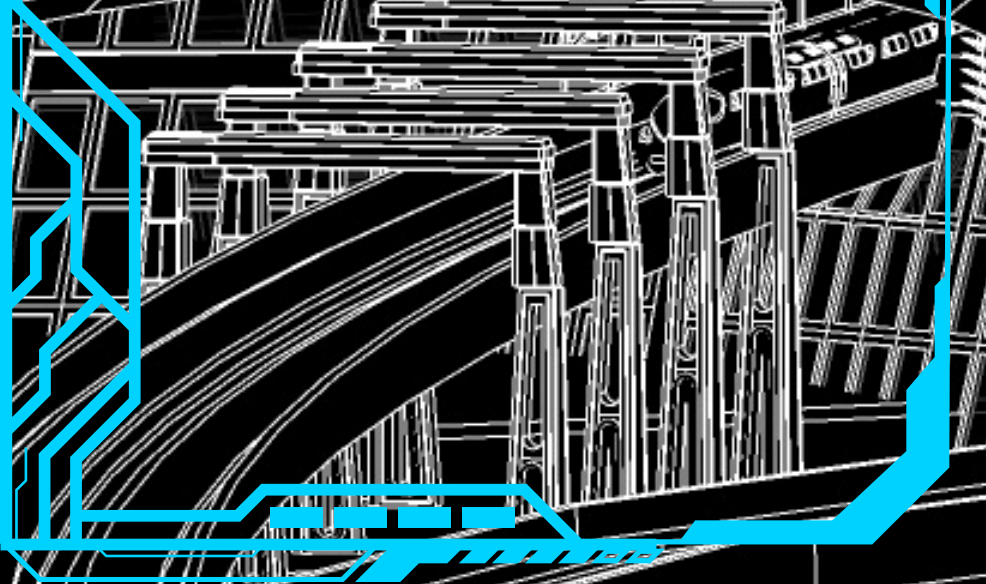

MUSEUM

